

CELEBRATING SPECIAL OCCASIONS



WELCOME
TO THE
****HOTEL METROPOLE
INTERLAKEN

2025



WELCOME

YOUR EVENT IN OUR HANDS

We offer the perfect framework for your special occasion from a small appetizer to a big celebration. Elegant premises plus our two restaurants are available to you for up to 200 people.

We are pleased that you are interested in holding a banquet at the Hotel Metropole - please feel free to contact us. We are happy to advise you over the phone, by e-mail or personally (by appointment) on our premises.

Your team marketing and events



Laura Schilling

Events, banquets and seminars



Caroline Zimmermann

Marketing



Kira Kamp

Reservation

Phone: +41 (0)33 828 66 66 | E-Mail: events@metropole-interlaken.ch

Table of content

Situation and route descriptions	Page	03-04
Rooms	Page	05
Relaxation	Page	06
Gastronomy and banquets	Page	07
Premises.....	Page	08-10
A - Z.....	Page	11-13
Events, Supporting program	Page	14

SITUATION AND ROUTE DESCRIPTION

HOW YOU MAY FIND US

The Hotel Metropole is situated in the center of the beautiful mountainous area of the Bernese Oberland. It towers majestically over the roofs of Interlaken. The possibilities for trips to the Jungfrau area are almost limitless and you may easily reach your destinations either by train or car, on foot, by taking a steam ship or by riding in a gondola.



Travelling by car

The Hotel Metropole is situated at the famous "Höhematte" (meadow) in the heart of Interlaken. Most shops and stores, restaurants and the Congress Center Kursaal Interlaken are easily accessible on foot. We recommend to take the exit "Interlaken Ost" and drive towards the center. The Hotel Metropole is the tallest building in town.

Parking possibilities

The Hotel Metropole has a garage (reservation available on request) and outside public parking.

Rate per parking space and night:	Garage	CHF 14
	Outside parking	CHF 8

Travelling with public transportation

It is only a 5 minutes' walk from the train station "Interlaken West" to the hotel. From the train station "Interlaken Ost" please plan on a 15 minutes' walk (taxi cabs and public busses are available). There are outstanding connections to Interlaken. Please find train connections for your trip under www.sbb.ch.

SITUATION AND ROUTE DESCRIPTION



WIE SIE UNS FINDEN

Inmitten der wunderschönen Berglandschaft im Berner Oberland liegt das Hotel Metropole. Majestätisch überragt es die Dächer von Interlaken. Die Ausflugsmöglichkeiten in der Jungfrauregion sind nahezu grenzenlos und mit Zug, Luftseilbahn, Auto, Fahrrad, zu Fuss oder Dampfschiff meistens leicht erreichbar.



PARKING POSSIBILITIES

1. AT THE HOTEL METROPOLE

The Hotel Metropole has a garage (reservation available on request) and a public outside parking. We kindly inform you that we cannot guarantee any parking spaces on our car park because it is a public parking. For the outside parking we charge CHF 8.00 and for the garage CHF 14.00 per night.

2. AT THE RIVER "AARE"

You may find more public parking spaces which are suitable for long term parking behind the Congress Center Kursaal Interlaken on the banks of the river Aare (Strandbadstrasse) which is a 5-minutes' walk from the Hotel Metropole. It is possible to get a day ticket at the reception of the Hotel Metropole for CHF 10.00 (Prices from 2015 - valid for 24 hours).

3. PARKING GARAGE INTERLAKEN "PZI"

The public parking garage in Interlaken "PZI" is located directly at the "Höhematte" (Jungfraustrasse), next to the Art house. It's only a 3-minutes' walk to the Hotel Metropole.

ROOMS

BEAUTIFUL VIEWS...

Thanks to the unique type of construction not found anywhere else in the area, all rooms have a spectacular view. 84 of the 96 rooms provide a balcony and an exclusive view onto the Jungfrau Mountain!

Rooms

The Hotel Metropole has four room categories: The 42 standard rooms are located on the 1st to 6th floors. On the 7th to 14th floors, above the rooftops of Interlaken, are our 54 newly renovated Deluxe rooms, each with a suite on the 13th & 14th floors. These also have a spacious living area and are equipped with a corner bath and shower cubicle. We also offer 12 rooms without balcony on the 1st to 12th floor. No matter which category you choose, you can expect simple elegance combined with functionality and all the comforts of a four-star hotel.



RELAXATION

FITNESS & RELAX...

Would you like to relax after a busy day in the Jungfrau region? Let the day pass by during a fitness training or at the sauna.

Fitness, Sauna and Massage

The modern and brightly designed fitness room with a total of 10 workout devices (cardio and weight training) is available to you 24 hours a day. Of the devices you enjoy a wonderful view of the famous mountain range of the Jungfrau.

It is very relaxing to enjoy a sauna when the outside temperatures drop. It will boost your circulation and is pure wellbeing for body and soul. The complete sauna area was renovated in 2014.

Give yourself extra relaxation and arrange an appointment for a massage.

Lounge

In the new lounge our business corner (two workstations and a printer) are available to you. The cozy sofas, self-service corner and the spacious terrasse invite you to relax.

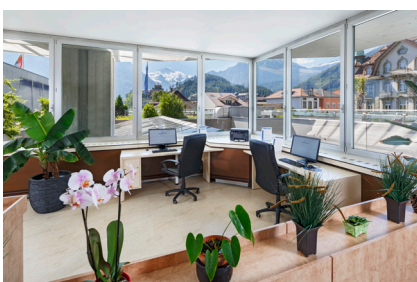

GASTRONOMY & BANQUETS

APPETIZERS, COMPANY PARTIES, FAMILY BANQUETS

Whether you are planning on having a small spontaneous appetizer or an extensively tailored menu, we can offer elegant and various premises as an ideal framework for your successful event up to 200 people. You may also reserve the Panoramic Restaurant Top o'Met with its beautiful views exclusively for your event or hold it in one of our banquet rooms.

It is with great pride that we can offer a choice of smaller and bigger delicacies, all prepared with great care, freshly cut and delivered from the local market. Please enjoy and be surprised by our various and seasonally changing menus in our Specialty Restaurant Bellini with its sophisticated ambience or in our Panoramic Restaurant Top o'Met with its fantastic views.

We are looking forward to welcoming you in our restaurants or in our banquet rooms!

PREMISES

Panoramic Restaurant Top o'Met, 18th floor

The Panoramic Restaurant Top o'Met offers splendid views onto the lakes of Thun and Brienz combined with elevated culinary menus. It is also possible to book the restaurant exclusively against a minimal sales turnover.



Speciality Restaurant Bellini, 1st floor

You may enjoy our exclusive cuisine in the stylish atmosphere of the Bellini under the competent guidance of our chef and his crew.



Banquet rooms & Foyer Oberland, 1st floor

Our banquet rooms on the first floor are suited in an excellent way for your event for up to 200 people. Smaller or private events are also well suited within the framework of a banquet room on the first floor.



Metro Bar, Lobby

The Metro Bar impresses with its very special atmosphere. Reflect on a memorable day spent in the Jungfrau region with a glass of wine at the Metro Bar.



Our appetizer and menu suggestions are valid starting at 10 people and up. We are happy to present you with our individual and nonbinding offer.

PREMISES

PREMISES

1st floor

Banquet rooms Salon I-III or Salon I-VI

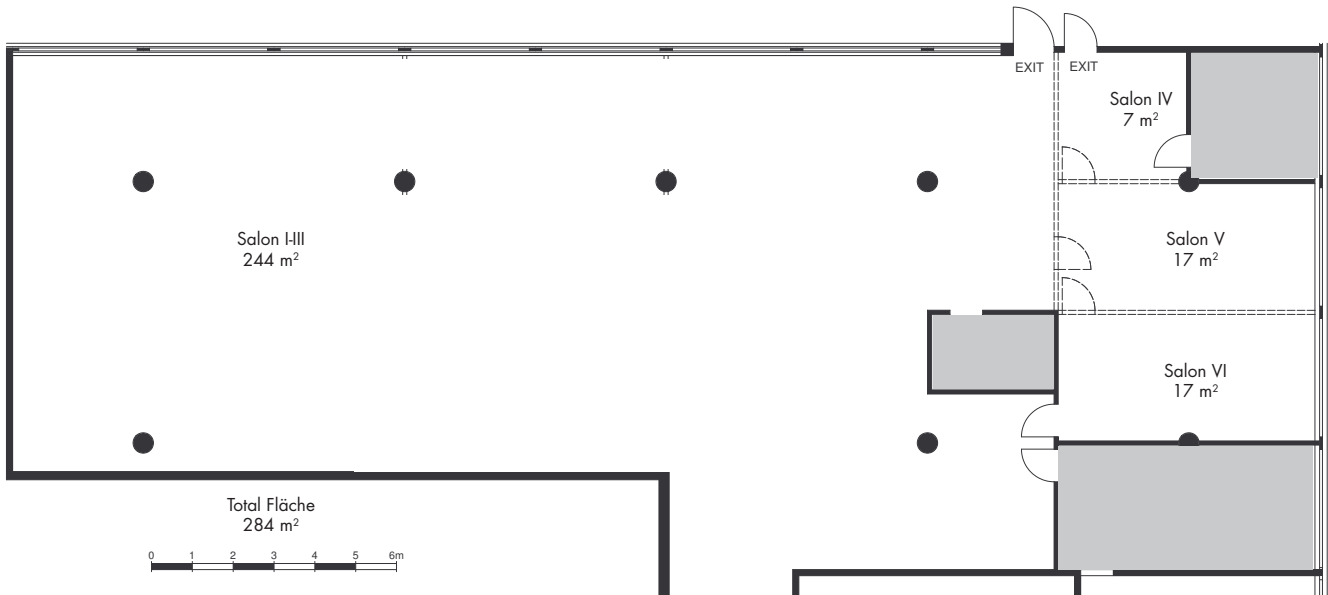

1st floor

Banquet rooms Salon VII-IX ("Oberlandsaal")

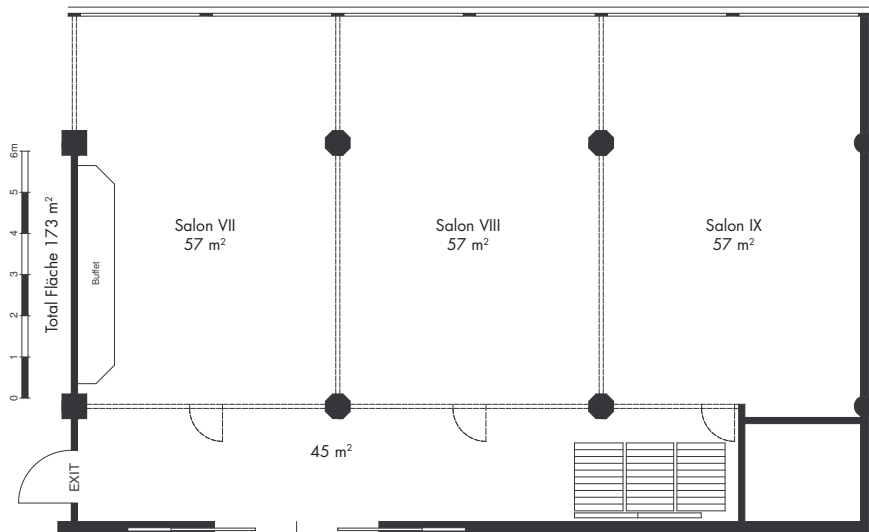

PREMISES

CHAIR ARRANGEMENT POSSIBILITIES AND CAPACITIES

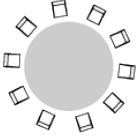
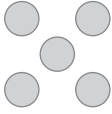
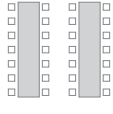
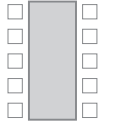
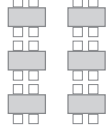
	 Banquet (round tables)	 Aperitif (Bar tables)	 Long table(s)	 Block table	 Restaurant seating	Air- conditioning	Day- light
Salon I-VI (284m ²)	200	300	-	-	-	✓	✓
Salon VIII or IX (each 57 m ²)	40	} 10 - 260	40	-	-	✓	✓
Salon VIII/IX (115m ²)	100		-	-	-	✓	✓
Salon VII/VIII/IX (173m ²)	130		-	-	-	✓	✓
Panoramic Restaurant Top o'Met, 18 th floor	-	10 - 120	10 - 12 per table	47	70 ¹⁾	✓	✓
Speciality Restaurant Bellini, 1 st floor	-	-	10 - 18 per table	24	70 ¹⁾	✓	✓
Foyer Oberland	-	64	-	-	-	✓	✓
Metro Bar	-	-	on request	-	-	✓	✓
Terrazzo	-	-	on request	-	-	-	✓

It is also possible to exclusively book our Panoramic Restaurant Top o'Met for your event. Please note that depending on the requested seating arrangement and the number of people a reservation is necessary. We are happy to present you with a detailed and nonbinding offer customized to your event.

Additional chair arrangement possibilities on request

¹⁾ = Capacity without seating request and buffet



Allergy sufferers

We respect the special needs of allergy sufferers. Please let us know 48 hours prior to the events of any consideration we should be taking.

Appointment (review of the menu and inspection of the hotel)

We are glad to show you our premises and present a customized offer taking into account your special wishes.

Birthday and wedding cakes

Please let us know your special wishes and we are happy to organize the right cake for you.

Cancellation policy

The reservation is binding as soon as we receive your signed confirmation. We will inform you about our cancellation policy with our first offer.

Children

We gladly consider the special tastes of our smallest guests. Our chef offers an attractive children's menu upon request.

Contact person

It is possible that questions arise during the event. We kindly ask you to give us the name of the contact person that we could contact during the event.

Dance floor

Both banquet rooms (Salon VII – IX and I – VI) offer enough space for a dance floor depending on the size of your event.

Extension

Will your party last a little longer? No problem. We are charging CHF 200.00 every hour or part thereof after midnight but for no later than 03.00 am.

Fireworks

For safety reasons it is strictly forbidden to ignite any kind of fireworks as well as any type of sparklers inside the building and on the terraces.

Invoice

You will receive a detailed invoice after your event with a payment slip. We gladly accept cash or the usual credit and debit cards in case you prefer to settle the bill on the spot.

Menu card

Would you like to bring along your own menu cards or would you like us to prepare them? We are open for your suggestions and would gladly integrate your logo or a photo.

Musical entertainment

We are glad to assist you in looking for the right musicians. However, it will depend on the style and the chosen volume on how long we can allow your entertainment.

Number of participants

In order to guarantee a perfect organization, we need your exact time schedule and number of participants. We kindly ask you to supply us at the latest 2 days before the event the agreed number of people. We do our best to accommodate if more participants will show up after that date; however, we will have to charge additionally for that time involvement.

Pre-payment

The Hotel Metropole is authorised to request a full or partial prepayment for the reservation. For events that are booked through a foreign invoice address a 100% pre-payment is necessary. This also applies to events that have been booked from abroad. Without further agreement the Hotel Metropole will submit a detailed invoice after the event.

Schedule

In order to guarantee a flowing process of our services, we kindly ask you to submit your exact schedule.

Social program

If you are looking for a social program, we are happy to assist you with choosing from numerous possibilities offered in Interlaken and the surrounding areas. We are sure that you will find just the right thing for you. For more information to this point, please see page 13.

Table decoration

Would you like to supply your own table decoration or can we take care of that for you? We supply candles free of charge in the evening.

Technical equipment

We offer several technical equipment such as microphones, loudspeaker, beamer, DVD player, television, overhead projector, screen etc. We will inform you about the rates on request.

Vegetarians

Our chef is pleased to prepare an alternative for vegetarians. Please let us know at least 48 hours prior to the event of any special wishes.

EVENTS, SUPPORTING PROGRAM

EVENTS

We are constantly organizing special events, such the Dinner Mystery shows, the 13-course Gourmet Dinner, a Sunday brunch and more. Please stay informed about our current events by checking on our webpage under "Specials" or contact us directly.



SUPPORTING PROGRAMS

Interlaken is the perfect starting point for many excursions into the mountains, onto the lakes, to go hiking or to arrange for a guided climbing tour. We can also arrange for a supported program through the hotel which depends on your available time in the region.

We would be pleased to submit an individual offer by our experienced partner [Jungfrau Tours](#). To guarantee your best experience on that outing, we kindly ask you to let us know your expectations in regards to time, budget and profiles of participants.

